

10713-111 19" FAN UNIT, 1 U, WITH FRONT SWITCH, 3 FANS, 24 VDC

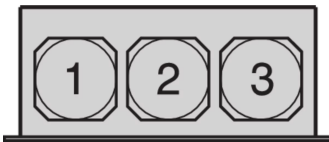
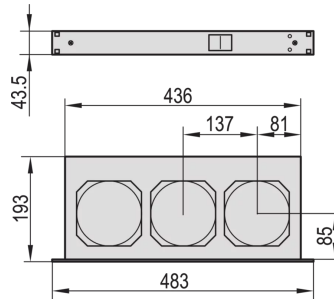

KEY FEATURES

Can be adapted to subracks

Contact protection in accordance with DIN EN ISO 13857

PRODUCT ATTRIBUTES

Product Type: Fan Unit

Input Voltage DC: 24 V min

ADDITIONAL PRODUCT DETAILS

Front-mounted, illuminated mains switch on AC devices, coupled with additional rear mains outlet; mechanical strain relief for mains input and mains output cables.

Please order mains cable separately.

Wide-range input voltage (86-...-264-VAC) available on request.

CERTIFICATIONS

ROHS
COMPLIANT

CE

EAC

North America

All locations
+1.763.422.2661
Chat with us:
schroff.nvent.com

Europe

Straubenhardt, Germany
+49.7082.794.0
Betschdorf, France
+33.3.88.90.64.90
Warsaw, Poland
+48.22.209.98.35
Assago, Italy
+39.02.932.7141
Chat with us:
schroff.nvent.com

Asia

Shanghai, China
+86.21.2412.6943
Qingdao, China
+86.532.8771.6101
Singapore
+65.6768.5800
Shin-Yokohama, Japan
+81.45.476.0271
Chat with us:
schroff.nvent.com

Middle East & India

Dubai, United Arab Emirates
+971.4.378.1700
Bangalore, India
+91.80.6715.2001
Istanbul, Turkey
+90.216.250.7374
Chat with us:
schroff.nvent.com



Our powerful portfolio of brands:
nVent.com **CADDY ERICO HOFFMAN RAYCHEM SCHROFF TRACER**

© 2023 nVent. All nVent marks and logos are owned or licensed by nVent Services GmbH or its affiliates. All other trademarks are the property of their respective owners.

nVent reserves the right to change specifications without notice.